

# Stinger LED Switch Replacement

## REMOVAL

1. Remove facecap and tailcap (or tailcap/switch assembly).
2. Slide battery out of flashlight body.
3. Use a pair of snap ring pliers (or the Stinger switch module pliers, p/n 750163) to unscrew the retainer from the flashlight body.
4. Use a Philip's screwdriver to remove the two charge screws (located opposite the switch) that secure the charge plate to the flashlight.
5. Reinsert the battery and use it to push the switch module assembly free from the flashlight.
6. Push the switchboot down and into the body to remove it from the flashlight.

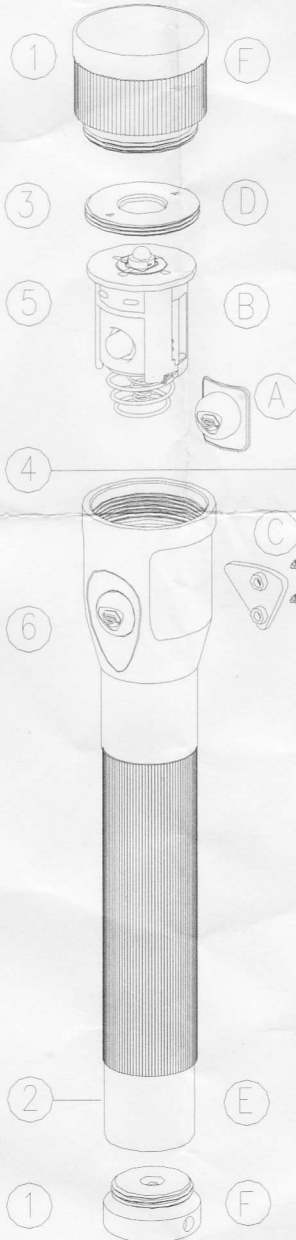

## REPLACEMENT

- A. Insert the new switchboot (SL logo oriented as shown) into the opening in flashlight barrel.
- B. Insert switch module into body and align switch so that the two mounting holes of the switch module align with the mounting holes for the charge screws.
- C. Insert the two charge screws through the charge plate and secure them in the mounting holes in the switch module.
- D. Insert the retainer into the head of the flashlight and tighten it to secure the switch module.
- E. Insert the battery into the flashlight body (double contacts toward head).
- F. Reinstall the facecap and secure the tailcap.